

MONTAGE INSTRCTION
Product Name: HM285 Trolley table
Prodcut ID-Nr: HB9027

HELLAND®
Furniture that cares

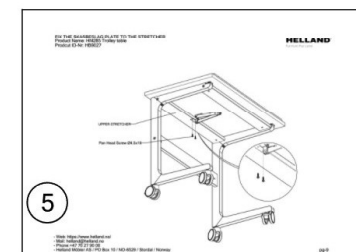
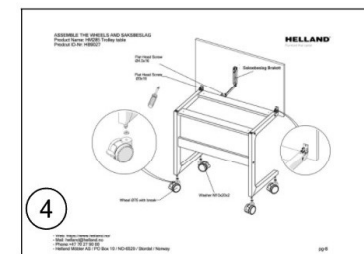
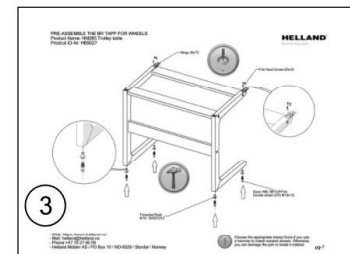
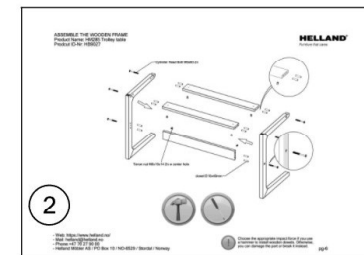
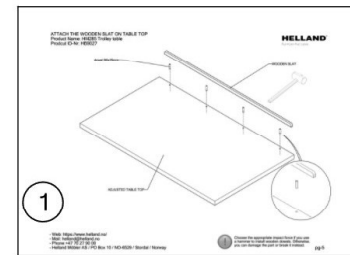
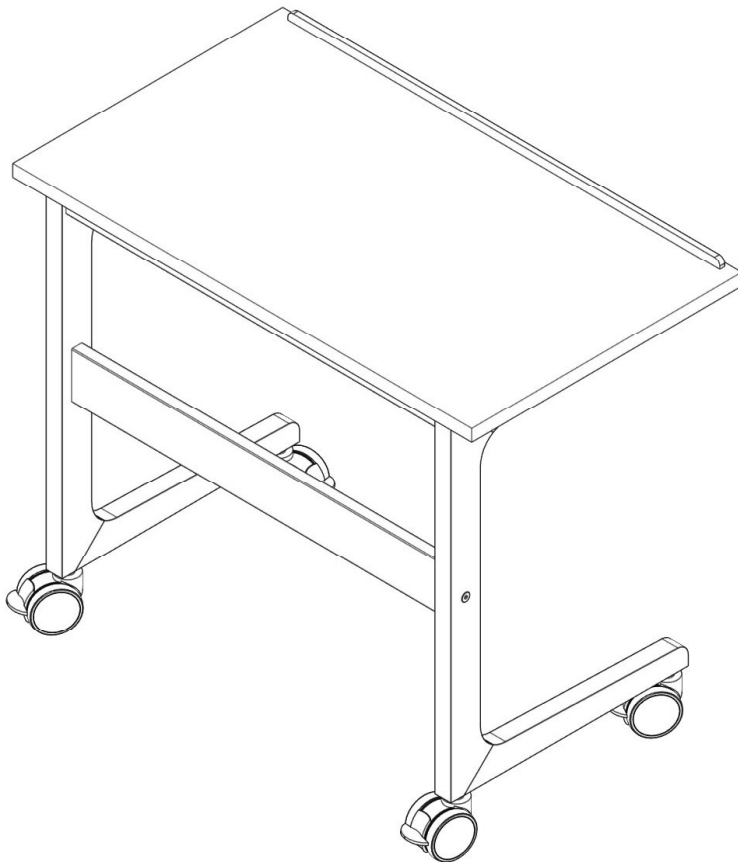

- Web: <https://www.helland.no/>
 - Mail: helland@helland.no
 - Phone: +47 70 27 90 00
 - Helland Möbler AS / PO Box 10 / NO-6529 / Stordal / Norway

BILL OF MATERIAL
Product Name: HM285 Trolley table
Prodcut ID-Nr: HB9027

BOM ID	Description	Qty
1	Cylinder Head Bolt M6x80 Zn	6
2	Duun HBC BRTAPP for Double wheel (S70 M10x15)	4
3	Flat Head Screw Ø3x16	12
4	Flat Head Screw Ø4.5x16	2
5	HB-11-001-T	2
6	HB-11-001-T_Mirror	2
7	HB-11-003-T	1
8	HB-11-003-T_Mirror	1
9	HB-11-004-T	3
10	HB-11-005-T	1
11	HB-11-006-T	1
12	Hinge leaf 26x72 inner	1
13	Hinge leaf 26x72 inner_Mirror	1
14	Hinge leaf 26x72 outer	1
15	Hinge leaf 26x72 outer_Mirror	1
16	Pan Head Screw Ø4,5x16	2
17	Saksebeslag Brakett	1
18	Saksebeslag Tannarm	1
19	Saksebeslag festeøre	1
20	Saksebeslag festeøre2	1
21	Tenon nut M6x10x14 Zn w center hole	6
22	Threaded Bush M10 - BA951210	4
23	Washer M10x20x2	4
24	Wheel Ø75 with break	4
25	dowel D10x40mm	12
26	dowel D6x25mm	4

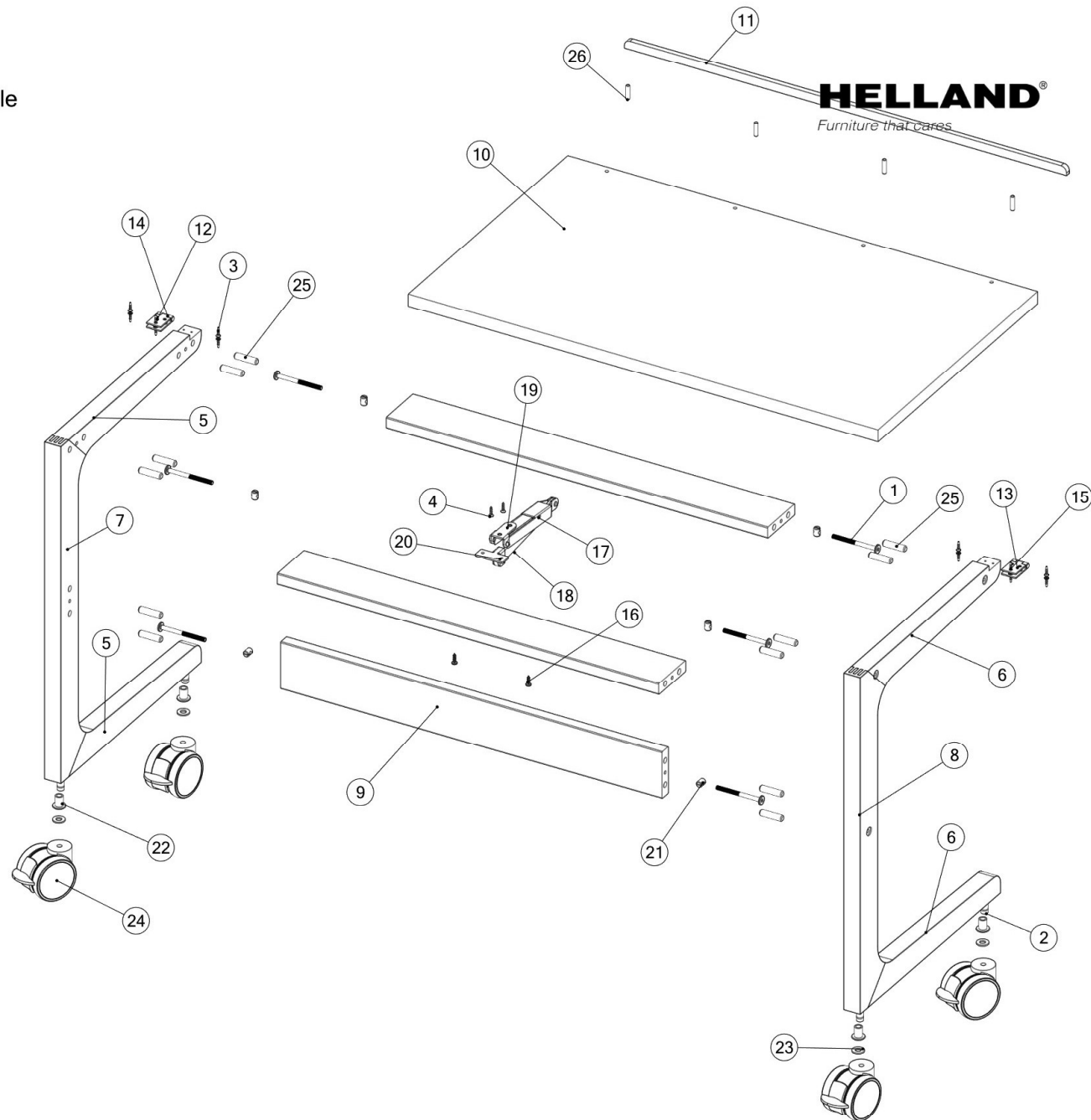

- Web: <https://www.helland.no/>
 - Mail: helland@helland.no
 - Phone: +47 70 27 90 00
 - Helland Möbler AS / PO Box 10 / NO-6529 / Stordal / Norway

LIST OF WOODEN PARTS

Product Name: HM285 Trolley table

Product ID-Nr: HB9027

HELLAND®

Furniture that cares

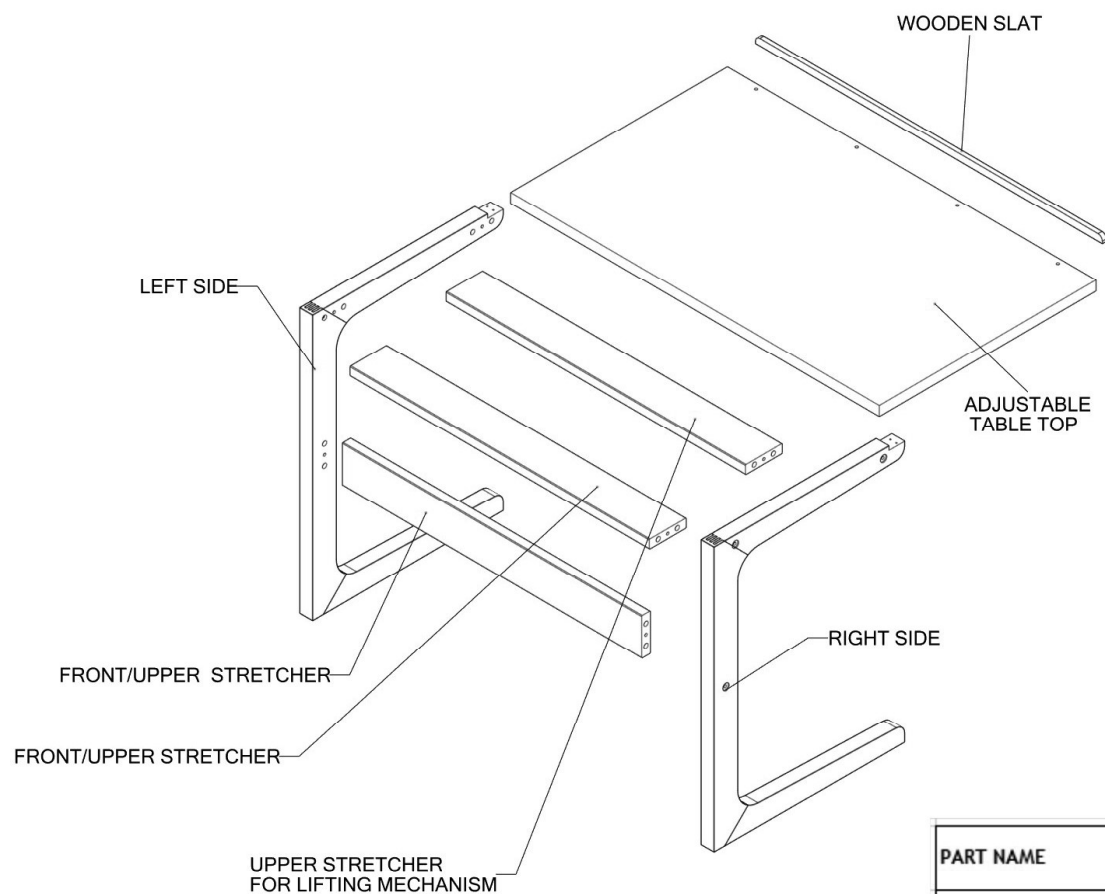

PART NAME	PCS PER PRODUCT
LEFT SIDE ASM	1
RIGHT SIDE ASM	1
FRONT/UPPER STRETCHER	2
UPPER STRETCHER FOR LIFTING MECHANISM	1
ADJUSTABLE TABLE TOP 850x500x22mm	1
WOODEN SLAT L800mm	1

- Web: <https://www.helland.no/>
 - Mail: helland@helland.no
 - Phone: +47 70 27 90 00
 - Helland Möbler AS / PO Box 10 / NO-6529 / Stordal / Norway

LIST OF FITTINGS

Product Name: HM285 Trolley table

Product ID-Nr: HB9027

HELLAND®
Furniture that cares



Washer M10x20x2
[4.pcs]



Dowel D10x40mm
[12.pcs]



Dowel D6x25mm
[4.pcs]

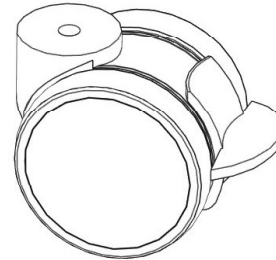

Wheel D75 with break
[4.pcs]



Threaded Bush M10
BA951210

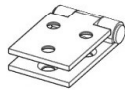

Hinge leaf 26x72
inner-outer/mir
[1+1.sets]



Tenon Nut M6x10x14 Zn
with center hole [6.pcs]



Flat Head Screw
D3x16 [12.pcs]



Flat Head Screw
D4.5x16 [2.pcs]



BR tapp for wheel [4.pcs]



Cylinder head bolt
M6x80Zn [6.pcs]

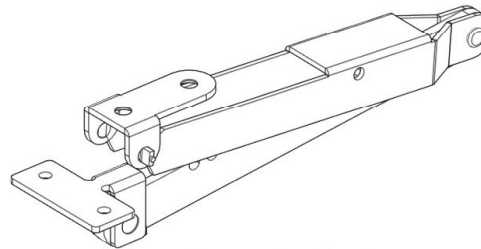

Saksbeslag [1.set]

ATTACH THE WOODEN SLAT ON TABLE TOP
Product Name: HM285 Trolley table
Product ID-Nr: HB9027

HELLAND®
Furniture that cares

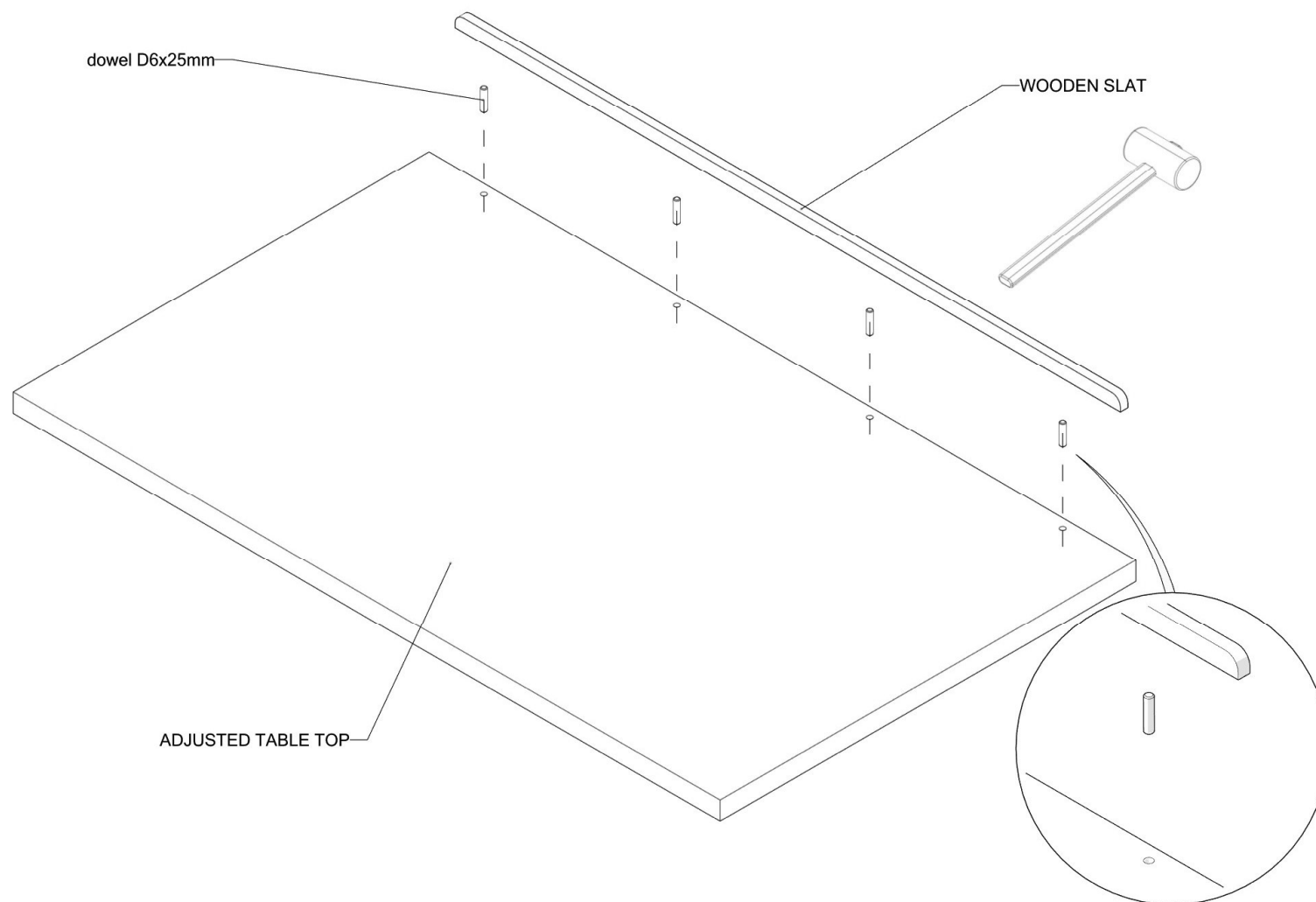

- Web: <https://www.helland.no/>
- Mail: helland@helland.no
- Phone: +47 70 27 90 00
- Helland Möbler AS / PO Box 10 / NO-6529 / Stordal / Norway



Choose the appropriate impact force if you use a hammer to install wooden dowels. Otherwise, you can damage the part or break it instead.

ASSEMBLE THE WOODEN FRAME
Product Name: HM285 Trolley table
Product ID-Nr: HB9027

HELLAND®
Furniture that cares

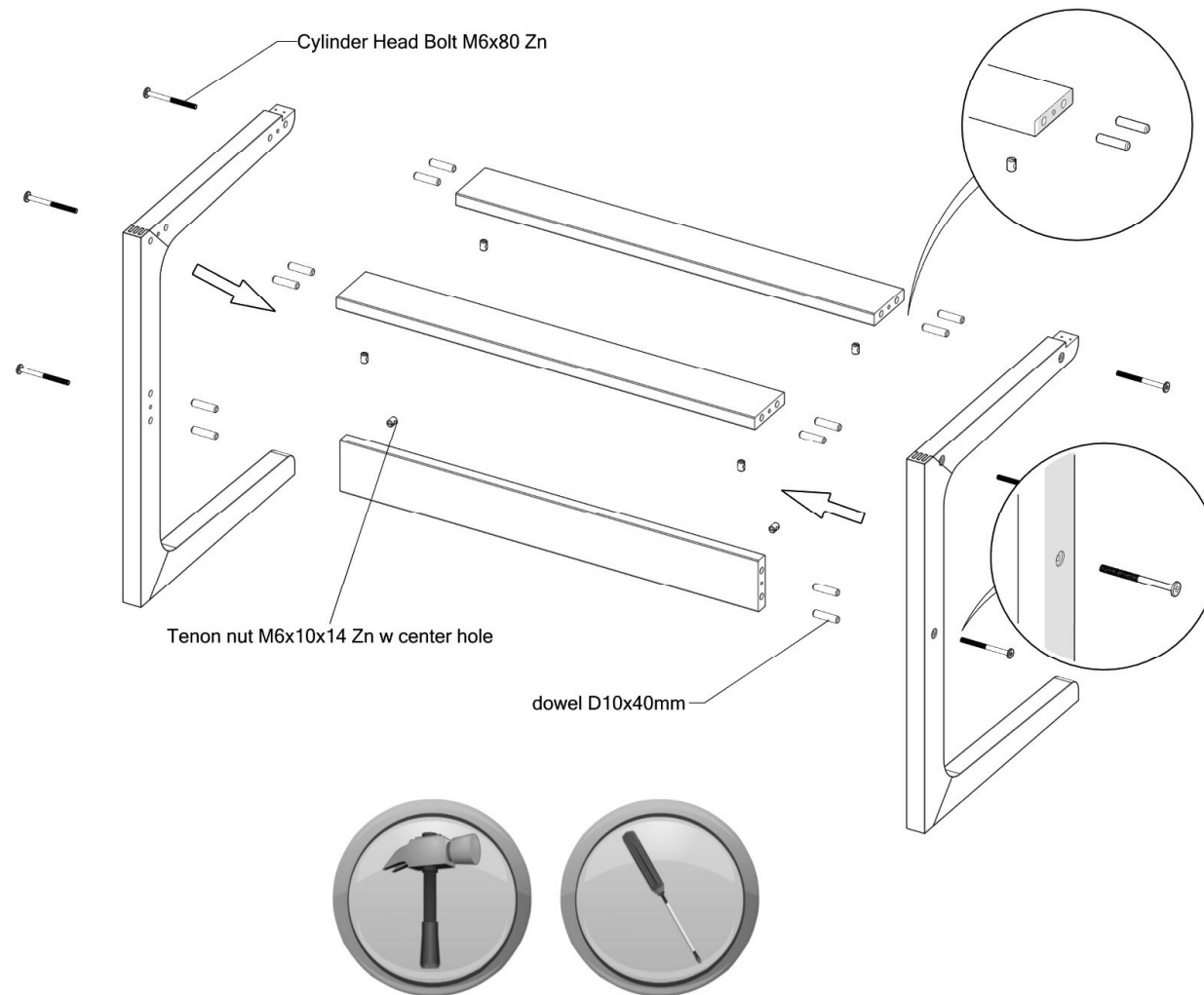

- Web: <https://www.helland.no/>
- Mail: helland@helland.no
- Phone: +47 70 27 90 00
- Helland Möbler AS / PO Box 10 / NO-6529 / Stordal / Norway



Choose the appropriate impact force if you use a hammer to install wooden dowels. Otherwise, you can damage the part or break it instead.

PRE-ASSEMBLE THE BR TAPP FOR WHEELS

Product Name: HM285 Trolley table

Product ID-Nr: HB9027

HELLAND®
Furniture that cares

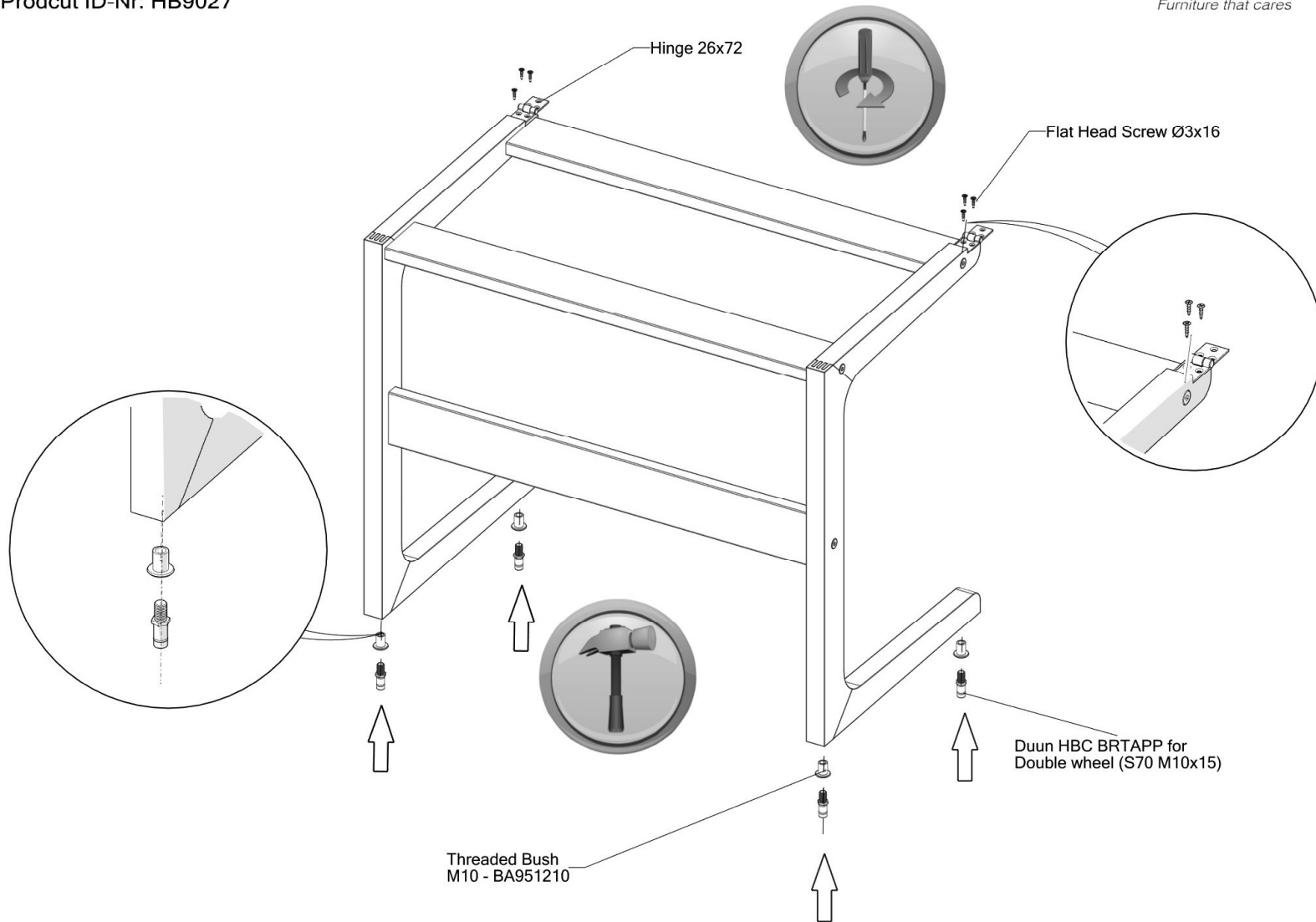

- Web: <https://www.helland.no/>
- Mail: helland@helland.no
- Phone: +47 70 27 90 00
- Helland Möbler AS / PO Box 10 / NO-6529 / Stordal / Norway



Choose the appropriate impact force if you use a hammer to install wooden dowels. Otherwise, you can damage the part or break it instead.

ASSEMBLE THE WHEELS AND SAKSBESLAG

Product Name: HM285 Trolley table

Product ID-Nr: HB9027

HELLAND®
Furniture that cares

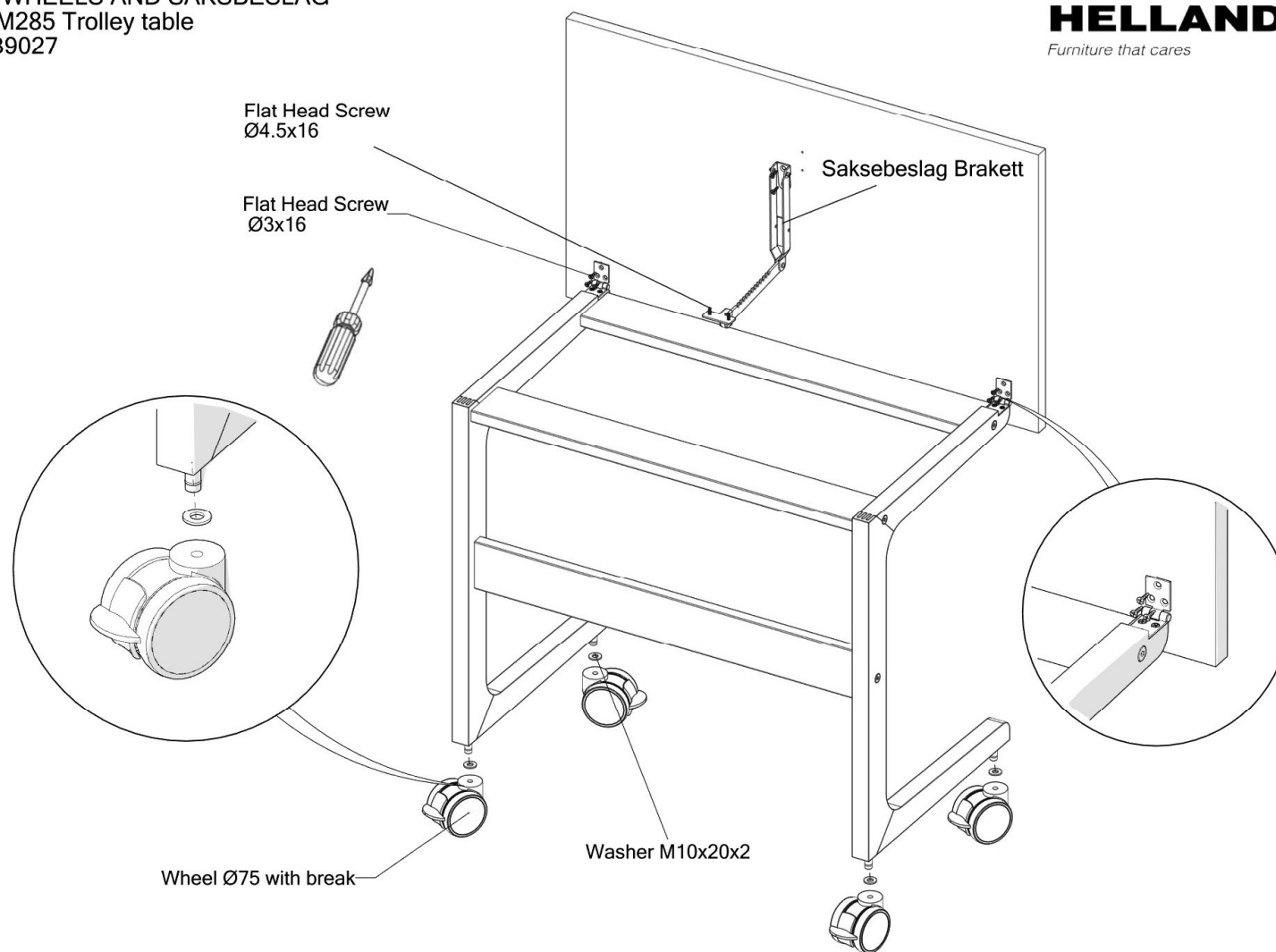

FIX THE SKASBESLAG PLATE TO THE STRETCHER
Product Name: HM285 Trolley table
Product ID-Nr: HB9027

HELLAND®
Furniture that cares

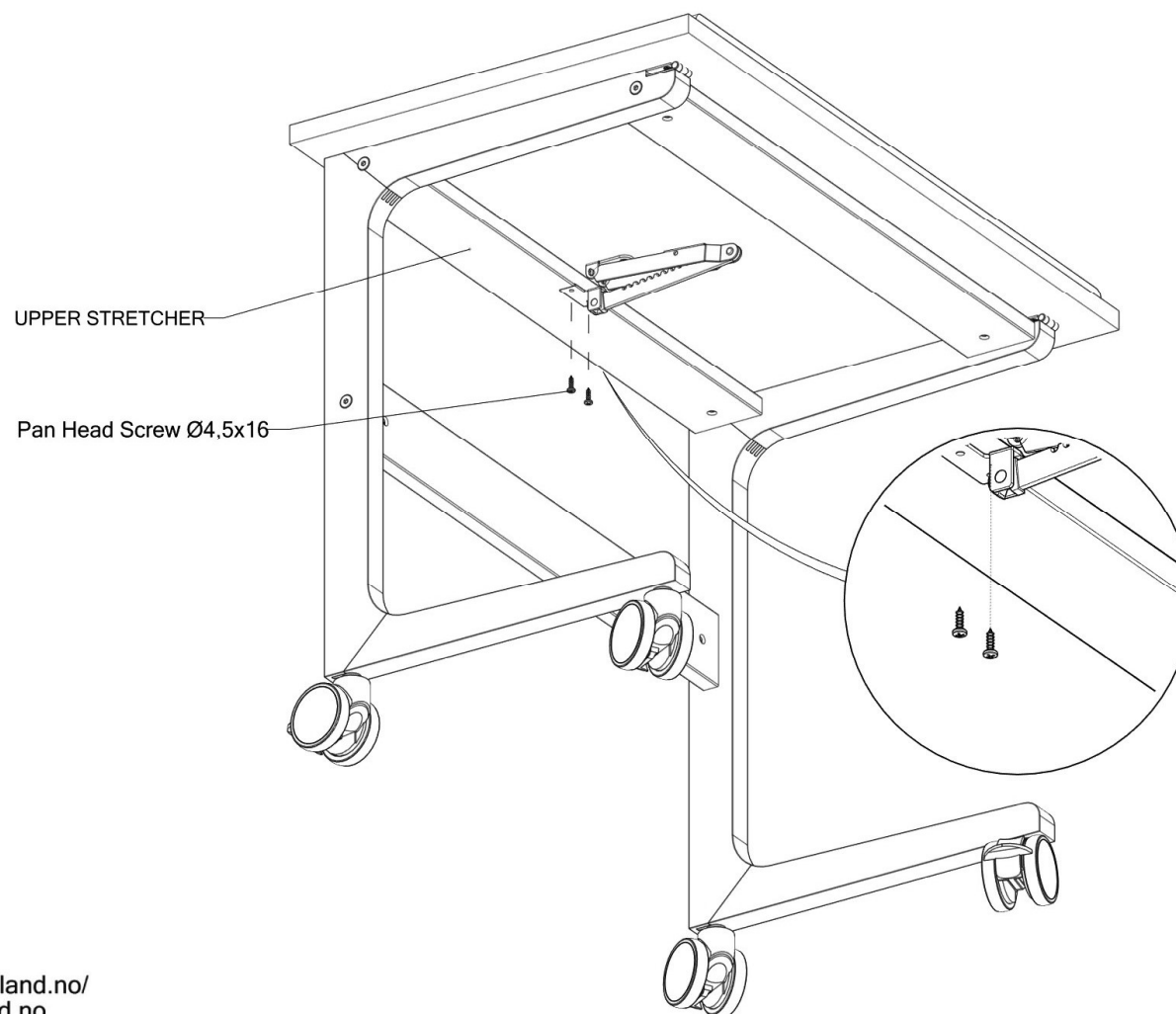

- Web: <https://www.helland.no/>
- Mail: helland@helland.no
- Phone: +47 70 27 90 00
- Helland Möbler AS / PO Box 10 / NO-6529 / Stordal / Norway